

NOTAS (NOTES):

- 1- DIFERENCIA DE CONEXION (CONNECTION DIFFERENCE) $7\pm 3.5^\circ\text{C}$
- 2- MAXIMA TEMPERATURA DEL CUERPO (MAXIMUM BODY TEMPERATURE) VDE 150°C / UL 120°C
- 3- CAPACIDAD DE MANIOBRA (POWER SUPPLY) 16A/400V~
- 4- LIMITES DE TEMPERATURA EN EL BULBO (TEMPERATURE LIMITS ON THE PHIAL) -10 Y 370°C
- 5- LAS TEMPERATURAS INDICADAS SON VALORES DE DESCONEXION (THE INDICATED TEMPERATURES ARE DISCONNECTION VALUES)
- 6- EJE DIBUJADO EN POSICION "0" (SPINDLE DRAW IN "0" POSITION)
- 7- FASTON 6,3 x 0,8 DIN 46244
- 8- LAS TEMPERATURAS SON MEDIDAS INTRODUCIENDO EL BULBO Y 80/100mm DE CAPILAR EN EL BAÑO A TEMPERATURA AMBIENTE DE $23\pm 3^\circ\text{C}$ (TEMPERATURES ARE MEASURED INTRODUCING THE PHIAL AND 80/100mm CAPILLARY IN THE BATH AT AMBIENT TEMPERATURE OF $23\pm 3^\circ\text{C}$)

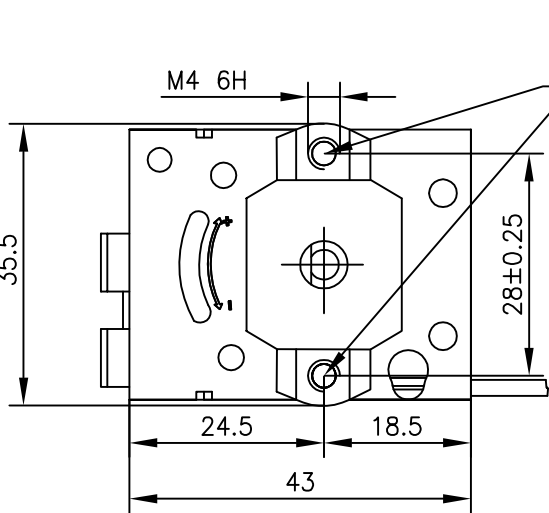
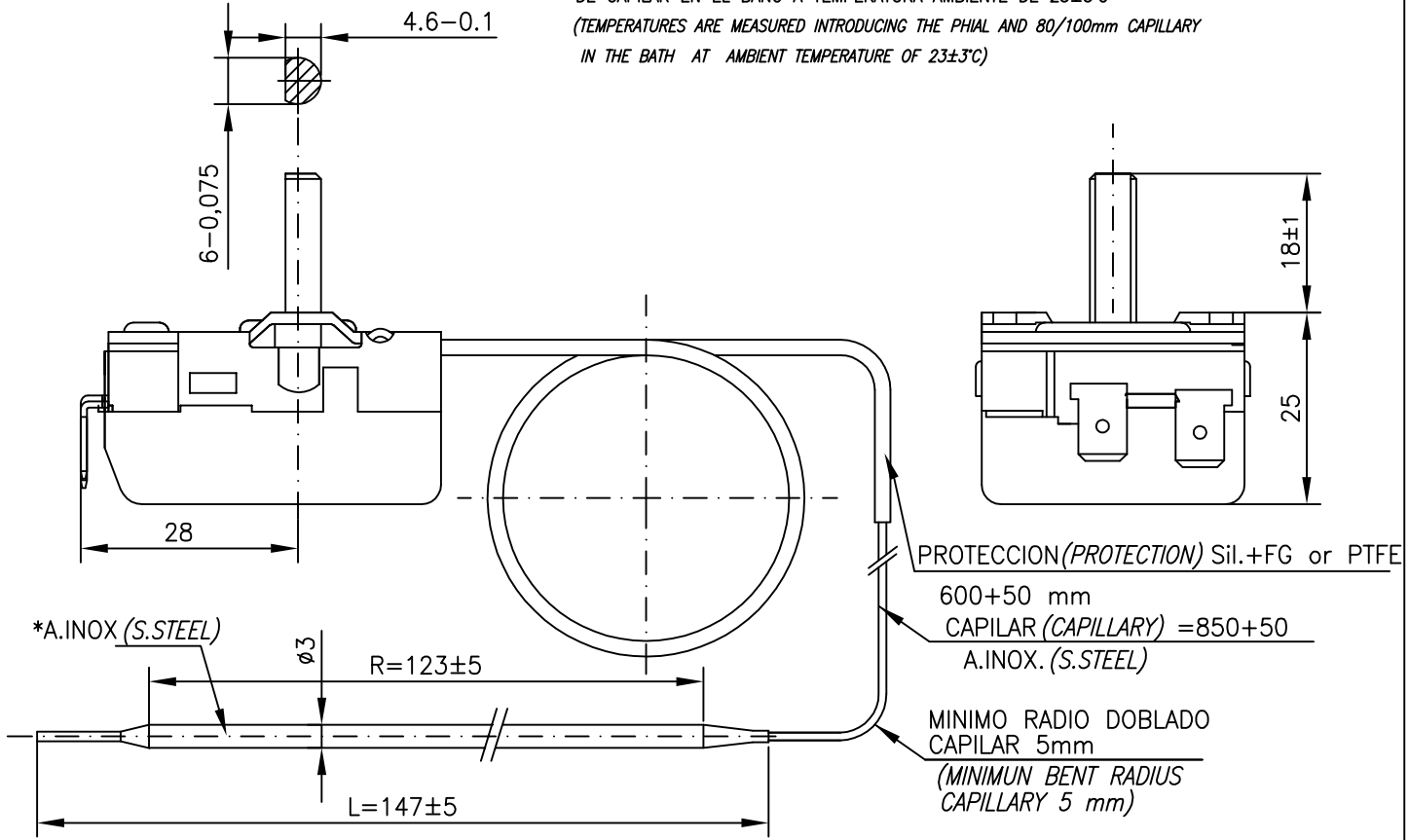

EN ESTOS AGUJEROS LA MAX. LONG. DEL TORNILLO SERA DE 11 mm MAS EL ESPESOR DE LA CHAPA
(IN THESE HOLES, THE MAX. SCREW LENGHT WILL BE 11mm PLUS PLATE THICKNESS)

CIRCUITO ELECTRICO POSICION DE DESCONEXION (ELECTRIC DIAGRAM) (OPEN POSITION)



DIAGRAMA DE TEMPERATURAS (TEMPERATURE DIAGRAM)



*N-783X		**N-40.864/4 (0.75)		DRAWN	REVISED	DATE
ISSUE				L.FDEZ.		24-06-99
REVISIONS	A) Modified material protection, before Sil.+Fib.			K.Arnal		15/12/04
	B) Modified protection material, before silicone. Updated flange, capillary exit. Deleted body temp. remark.			E.Mutlu	V.B.C	09/12/09
	C) Modified differential after customer approval			V.B.C		15/09/12

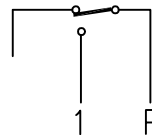
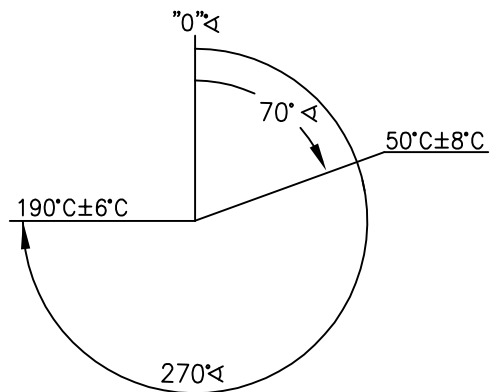

NT-232 GF

SCALE	THERMOSTAT
1:1	